

2013

Nex Venture

Nex Venture Techsupport

[E-MAIL SETUP GUIDE FOR ANDROID DEVICES]

This is a setup guide based on general practice, for special customization; please contact us for further information.

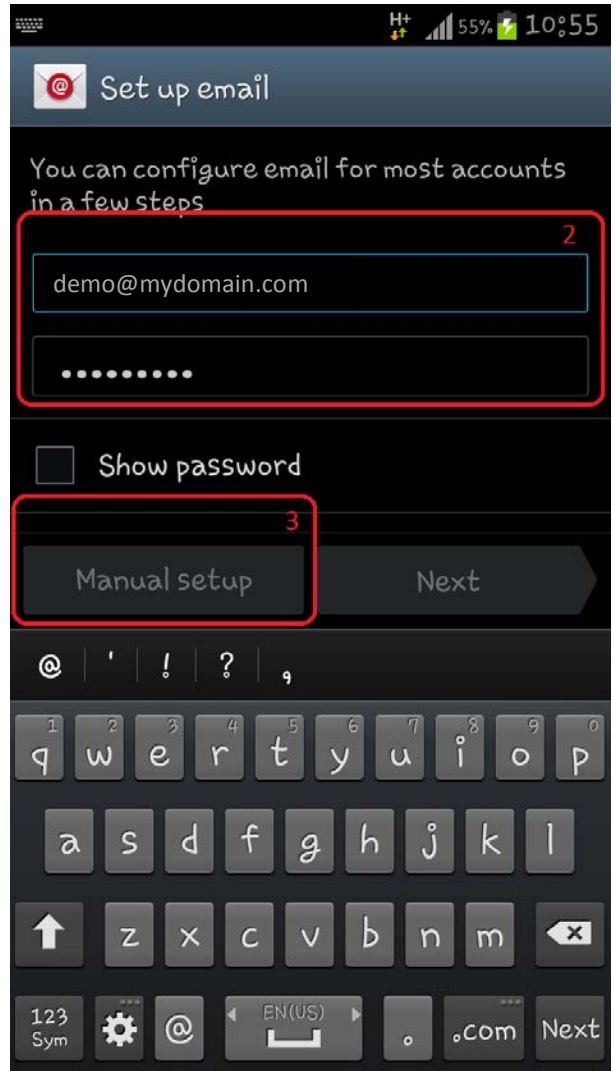
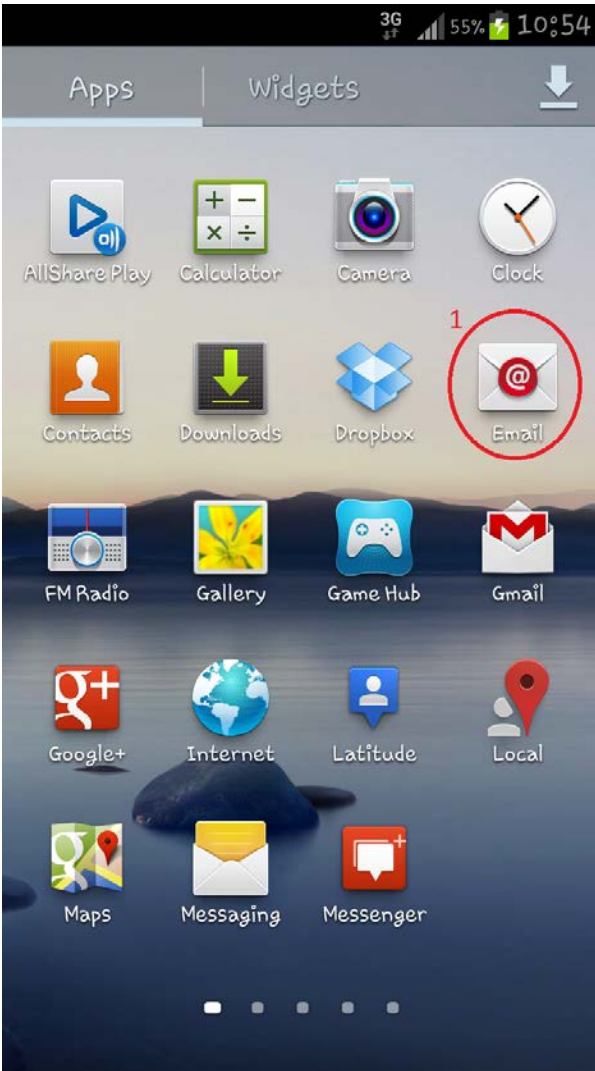

1. Click on your **Email** application that is installed by Default in your mobile.
2. Key in your login details accordingly.
3. Click on “**Manual setup**” once you have keyed in your login details correctly.



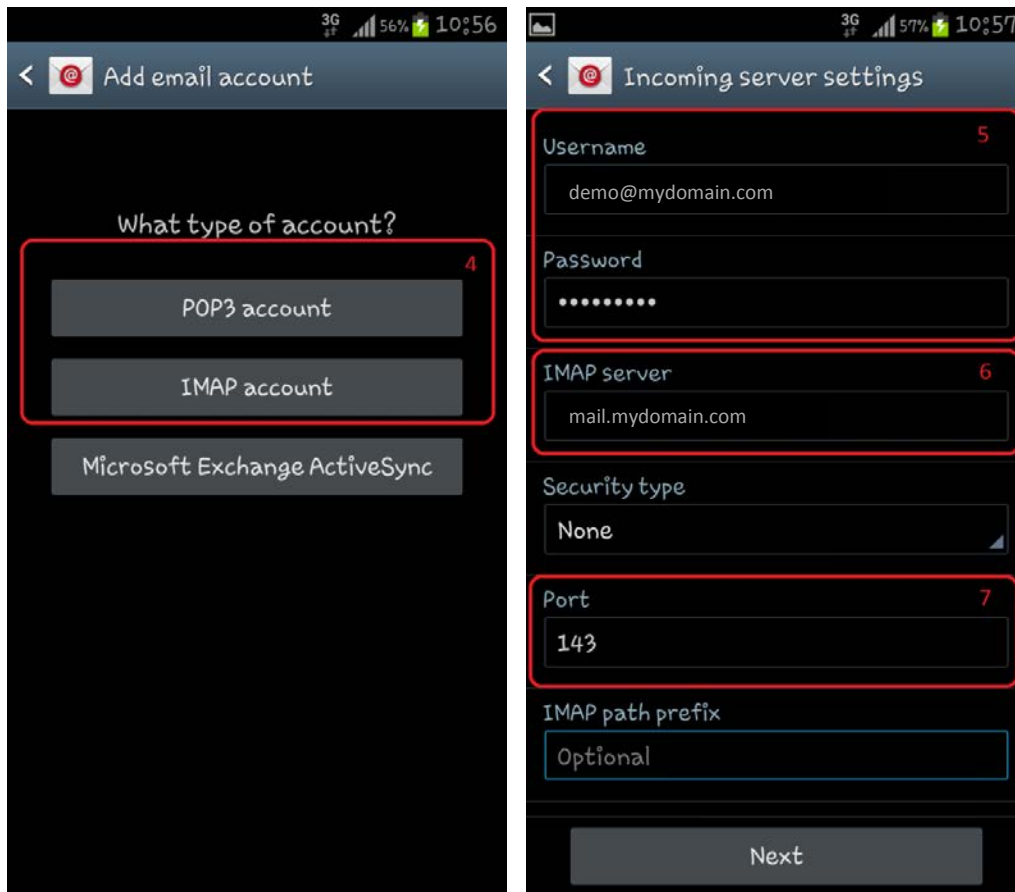

4. Choose accordingly whether you want a **POP3** setup or **IMAP** setup.

POP3 - Mails are deleted from server (web mail) as soon as user has downloaded the email into their 3rd party account (For this case, downloaded to this mobile).

IMAP - Mapping the emails onto Mobile Mail (synchronizing with web mail). So that user can view their emails on multiple platforms. (Please take note IMAP configuration is slightly slower than POP3)

5. Fill in the respective fields accordingly

Your Name : demo@mydomain.com

Email Address : demo@mydomain.com

Username : demo@mydomain.com (key in your full email address)

Password : *****

Incoming mail server : mail.mydomain.com

For pop3 setting only – under incoming setting, option “Delete email from server” make sure “Never” is selected.

6. IMAP/POP3 server **MUST** set to **mail.yourdomainname.com** (for example, mail.mydomain.com)

7. This field will be set by default **IMAP**Port is 143, and **POP3** is 110.



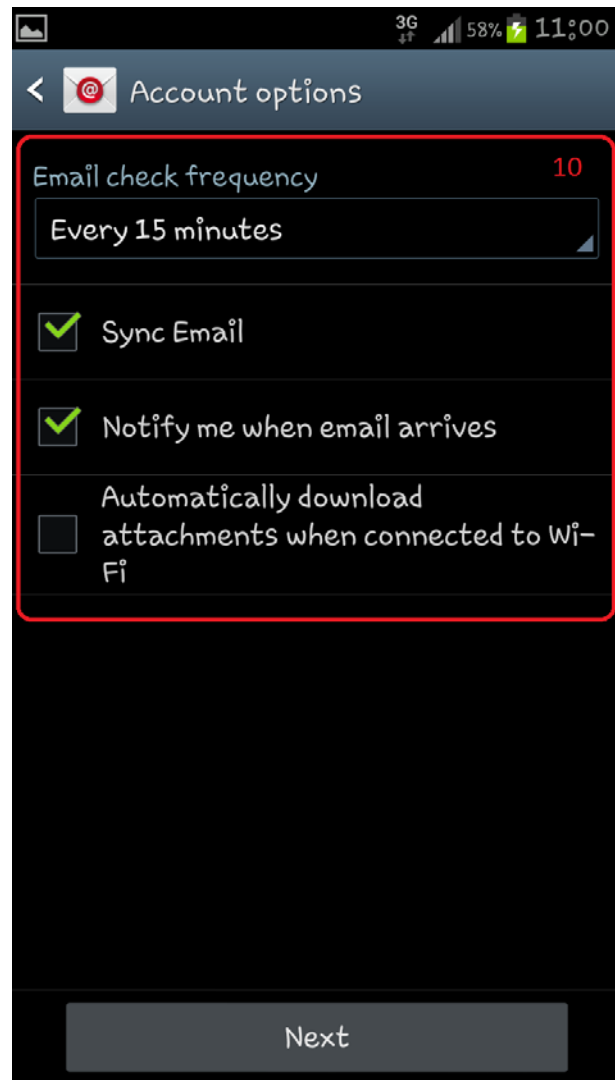
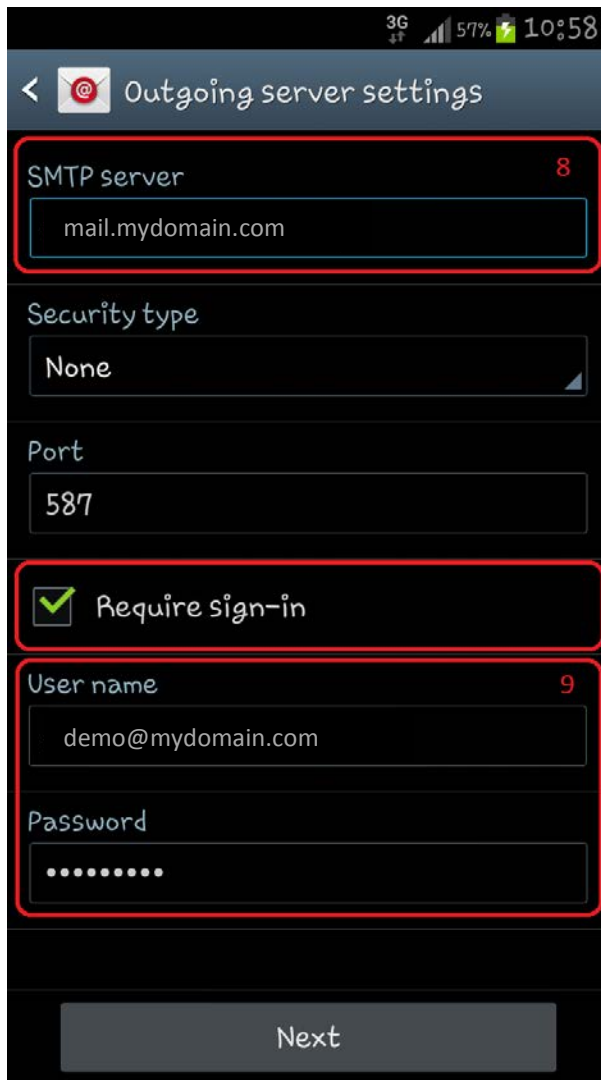

8. SMTP server **MUST** set to **mail.yourdomainname.com** (for example, mail.mydomain.com)
9. Ensure that require sign-in is checked
10. Key in your login details accordingly.
11. Set to your personal preference. And click on next and the setup is **Done**.

